

Tr 110x160 mm ebatlarındaki kavisli taşıyıcı ray profilleri ile maksimum 11 m'te açılım sağlanabilen, ön ve arka oluk entegreli kendinden taşıyıcılı açılır-kapanır pergola.

En Retractable free standing curved pergola system with curved conveyor rafters, max. 11 m projection with 110x160 mm conveyor rafter profiles (Integrated front and rear gutters).

Es Pérgola de lona móvil curvada autoportante, salida máxima de 11 m. con guías curvadas de 110x160 mm (Canalón frontal y posterior integrado).

Fr Pergola de toile rétractable courbée autoportante, projection maximum 11 mètres avec coulisses 110x160 mm (Gouttière frontale et postérieure intégrée).

De 110x160 mm große Öffnung kann durch die Tragschiene Profile zu einem Maximum von 11 m Freistehendes Pergola System öffnen und schließen Verfügung gestellt werden (Mit integriertem vorderen und hinteren Ablaufsystem).



Tr LUNA kavisli desteksiz açılır-kapanır pergola sistemi, açık alanların kötü hava koşullarında bile yıllarca kullanılmasına olanak veren gelişmiş bir çözümdür. Beaufort rüzgar skalası 11 şiddetine (117 km/saat) dayanabilen sistem, kara, yağmura ya da güneş ışığına karşı dayanıklı olarak tasarlanmıştır.

Sistemin profilleri, yüksek dereceli 6063 ekstrüzyon alüminyumdan, elektrostatik toz boya yöntemiyle boyanarak üretiliyor ve açık alan uygulamalarında üstün performans sağlıyor. Tüm civata, vida ve pimler, sistemin uzun ömürlü kullanılmasını sağlamak için yüksek kalite paslanmaz çelikten üretilmiştir.

En The LUNA curved free standing retractable pergola system provides an advanced solution to enable outdoor areas to be used in all weather conditions. The system offers a wind rating up to Beaufort class 11 (Up to 117 km/h) and is designed to stand up to even the worst of conditions rain, hail or shine.

The system is manufactured to size using high grade 6063 extruded aluminium profiles finished with thermosetting powder coating which provides superior overall performance for exterior product applications. All bolts, screws and pins are high grade stainless steel to ensure extended system life.

Es La Pérgola de lona móvil curvada autoportante LUNA proporciona una avanzada solución permitiendo utilizar áreas de exterior en cualquier condición climatológica. Ofrece una resistencia al viento clase 11 de la escala Beaufort (Hasta 117 km/h) y está diseñado para soportar cualquier climatología ya sea bajo la lluvia o el sol.

El sistema está fabricado a medida usando perfiles de aluminio extrusionado de alta calidad aleación 6063 lacados mediante recubrimiento en polvo que proporciona un excelente rendimiento para uso exterior. Tornillería de acero inoxidable de alta calidad para alargar la vida del sistema.

Fr La pergola en toile rétractable LUNA courbée autoportante, offre une multitude de solutions permettant de couvrir des espaces extérieurs dans n'importe quelles conditions climatiques. Résistance au vent de classe 11 sur l'échelle de Beaufort (Jusqu'à 117 km/h). elle est étudiée pour supporter n'importe qu'elle situation climatique, grêle, pluie et soleil.

Le système est fabriqué sur mesure, utilisant des profils extrudés de haute qualité norme 6063, finis avec revêtement en poudre thermodurcissable, qui offre une meilleure performance globale pour des réalisations en extérieur. Les accessoires sont en acier inoxydable de haute qualité pour une plus grande durée de vie du système.

De Die LUNA gebogenen freistehende versenkbare Pergola-System bietet eine fortschrittliche Lösung zu aktivieren Außenbereich in allen Wetterbedingungen eingesetzt werden. Das System bietet eine Wind-Rating bis zur Klasse 11 (Bis zu 117 km / h) Beaufort und ist entworfen, um sich gegen die schlimmsten Bedingungen regen, Hagel oder Sonnenschein sogar.

Das System ist an Größe mit hochwertigem 6063 Aluminium-Strangpressprofilen fertig mit duroplastischen Pulverbeschichtung, die überlegene Gesamtleistung für den Außenbereich Produkt-Anwendungen bietet hergestellt. Alle Bolzen, Schrauben und Stifte sind aus hochwertigem Edelstahl erweitert Lebensdauer des Systems zu gewährleisten.



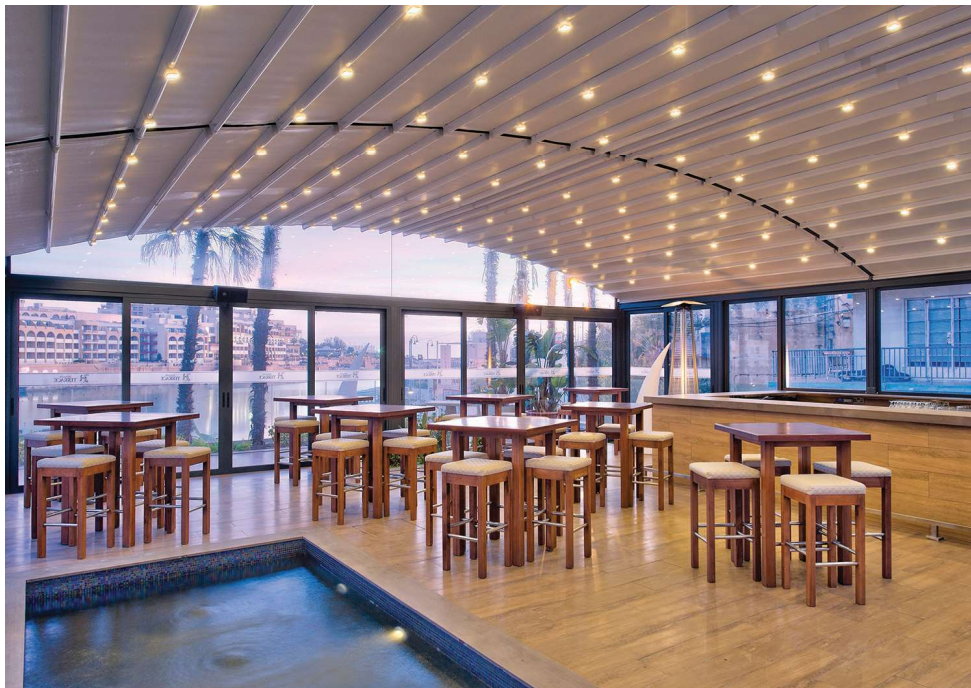



Tr Avrupa teknolojisi kullanılarak, sistemin uzaktan kumanda ile motorun dakikada 26 devir gibi yüksek hızla kontrolü sağlanıyor. Uzaktan kumanda kontrollü LED-TEC aydınlatma sistemi ile daha şık ortamlar yaratılabilirken, uzaktan kumanda kontrollü dimmer sistemle de kullanıcıyı çevreleyen ortama uygun ışık yoğunluğu sağlanabiliyor.

En Remote controlled motorisation is provided by utilising European technology through a custom built direct drive motor system to ensure smooth and quick operation at 26 RPM. The optional hi powered LED-TEC lighting system provides a practical touch of class and when coupled with a remote dimming controller allows the user to change the mood to suit the surrounding environment.

Es Motorización accionada mediante mando a distancia dotada de un sistema de transmisión directa para asegurar un desplazamiento rápido de la lona a 26 RPM. La opción de iluminación mediante LED proporciona un toque elegante, que unido a un regulador de intensidad de luz permite al usuario adaptar el espacio al entorno.

Fr La motorisation est réalisée par télécommande à distance de marque, dotée d'un système de transmission directe afin d'assurer un déplacement rapide de la toile à 26 RPM. L'option d'éclairage LED offre une touche élégante qui, unie à un régulateur d'intensité, permet à l'utilisateur d'adapter l'espace à son environnement.

De Ferngesteuerte Motorisierung wird durch die Verwendung europäischer Technologie durch einen speziell angefertigten Direct Drive Motor System eine reibungslose und schnelle Bedienung bei 26 RPM sicher gestellt. Die optional hallo betriebene LED-TEC Beleuchtung bietet eine praktische Hauch von Klasse und wenn sie mit einem Remote-Dimm-Regler gekoppelt ermöglicht es dem Benutzer, um die Stimmung zu ändern, um die Umgebung anzupassen.



Desteksiz 11 mt ye kadar ileriye açılım

Projections up to 11 mt without support

Salida hasta 11 m sin soportes

Projection maximum 11 mètres sans poteaux compensateur

Projektionen bis zu 11 m ohne Unterstützung





Tek parça kumaş ile 13 mt cephe genişliği

Width up to 13 mt in single fabric

Ancho hasta 13 mt con lona de una pieza

Largeur maximum 13 mètres avec une seule toile

Breite bis 13 mt in einzelnen Stoff

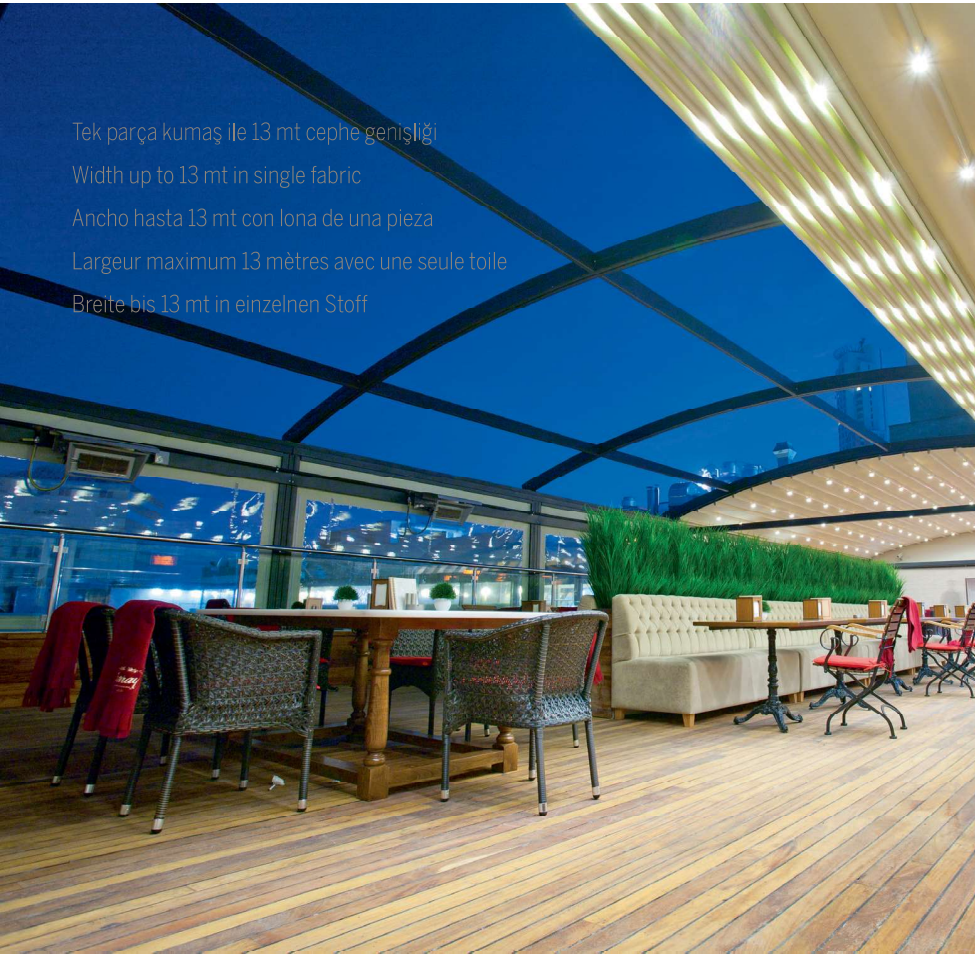



Luna

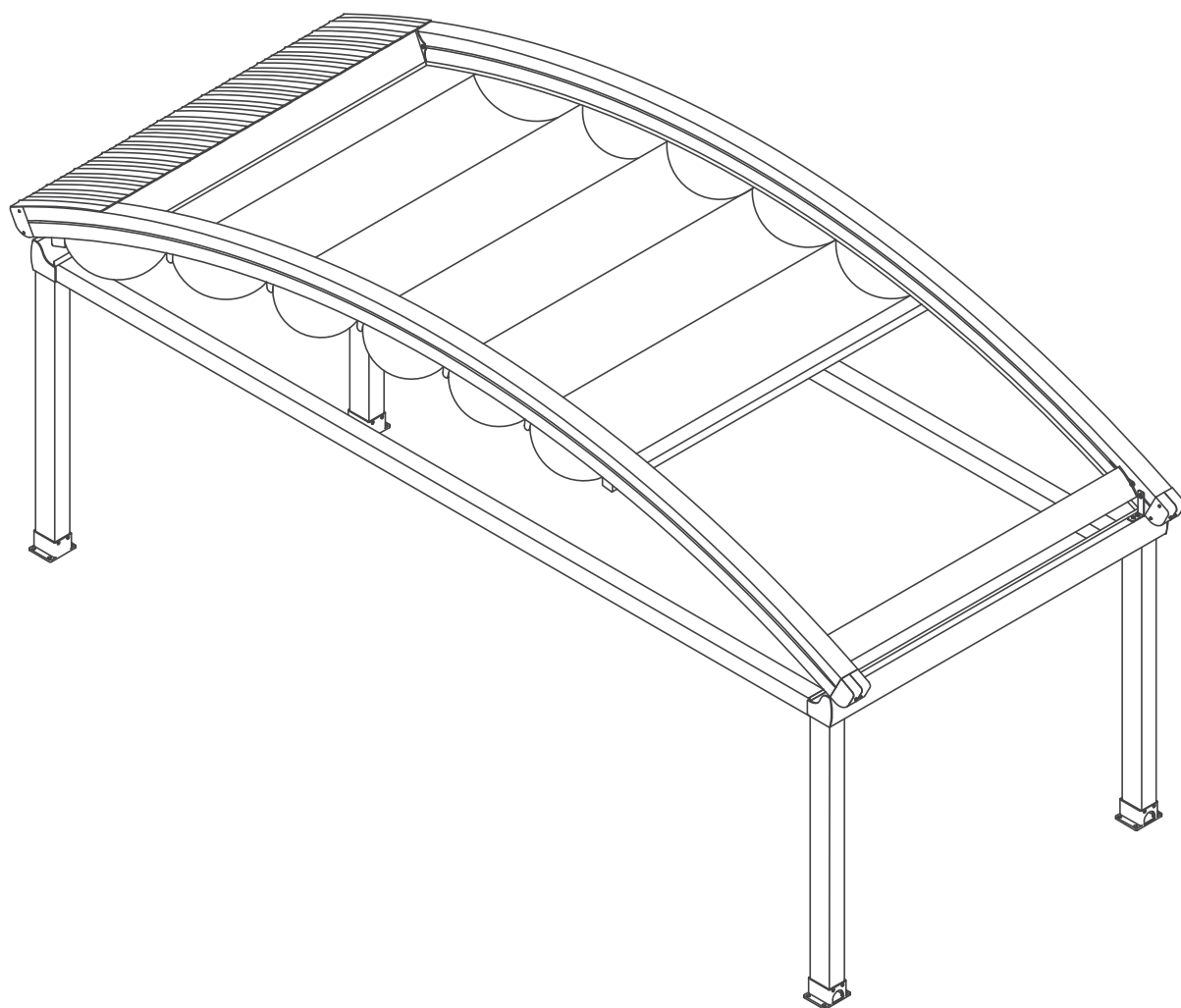

SUNTECH

Luna free standing retractable curved pergola system

The LUNA free standing retractable curved pergola system provides an advanced solution to enable outdoor areas to be used in all weather conditions. The system offers a wind rating up to Beaufort class 11 (up to 117km/h) and is designed to stand up to even the worst of conditions rain, hail or shine.

The system is manufactured to size using high grade 6063 extruded aluminium profiles finished with thermosetting powder coating which provides superior overall performance for exterior product applications. All bolts, screws and pins are high grade stainless steel to ensure extended system life.

The LUNA rafter profiles (LT: 80mm x 125mm / XL: 110mm x 160mm) have been designed with unique water guard side channels and cast aluminium end plates to allow for projections up to LT: 7m / XL: 11m per system. Widths are customised according to site requirements and available in any size up to 13m. The LUNA system offers up to LT: 91sqm / XL: 143sqm of weatherproof protection at the touch of a button.

Remote controlled motorisation is provided by utilising European technology through a custom built direct drive motor system to ensure smooth and quick operation at 26RPM. The optional hi powered LED-TEC lighting system provides a practical touch of class and when coupled with a remote dimming controller allows the user to change the mood to suit the surrounding environment.

The heart of the system is driven by the Suntech F3 eight wheel slider carriages (each F3 slider carriage has a load limit of 600kgs) that incorporates a triple layer barrier system and works in conjunction with a timing belt that has been reinforced with multiple internal stainless steel cables to provide a pulling strength of 966kg. It's this tension that is applied to the fabric membrane and ensures all water drains away in the dual internal gutter systems.

The fire rated and 100% waterproof architectural membrane is available in a range of colours in both opaque and transparent that provides maximum stability and resistance to temperature, moisture and dirt. It does not shrink or bag, and the acrylic top coating makes it very easy to clean for years to come. When not in use the fabric is neatly retracted under the systems hood to provide protection from the elements when not required.

To ensure the highest level of protection Suntech systems focus on all the details, this is why all Suntech systems come standard finished with Stormguard soft touch edge seal on all parameters. Stormguard provides the ultimate protection against rain and draught intrusion around the outside of the system and is only available on our systems. Stormguards soft touch edge seal is produced from an extra soft & flexible rubber to ensure the best possible protection from the elements.

Luna

One Module

200 cm > 400 cm
One Module with one motor & 2 rafters

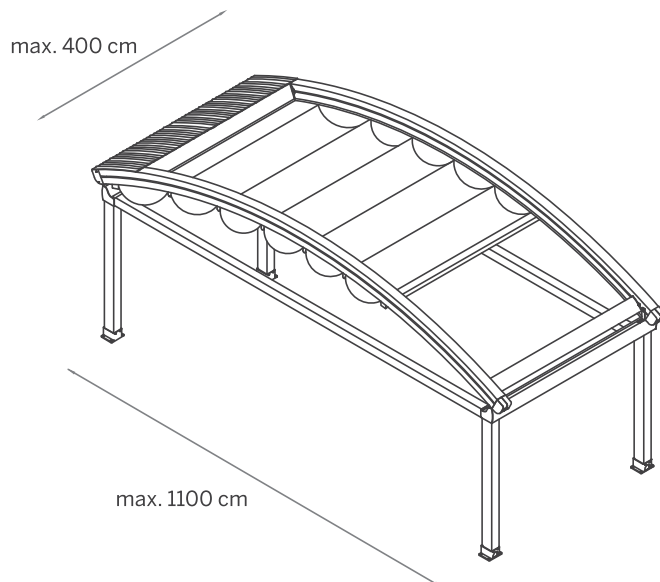

Two Modules

400 cm > 800 cm
Two Modules with one motor & 3 rafters

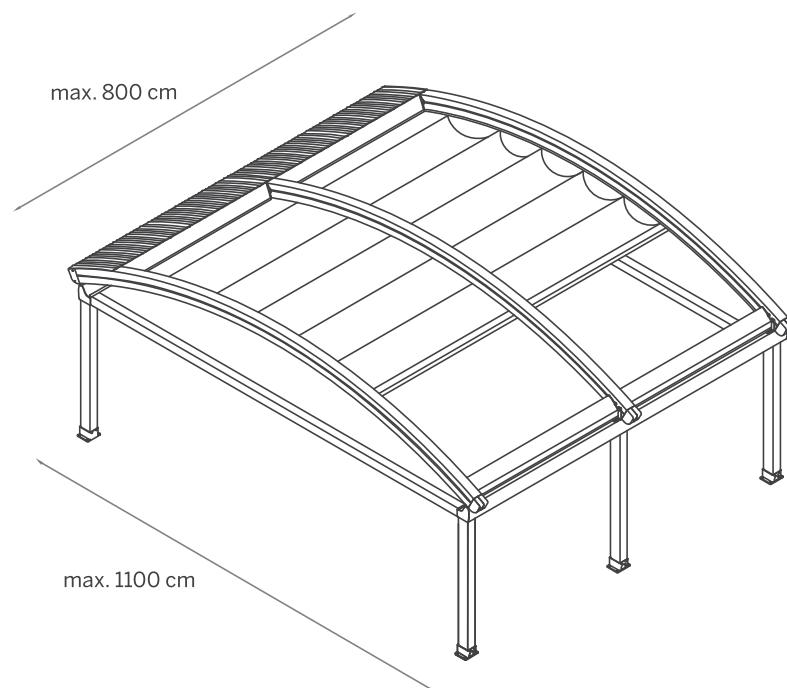

Three Modules

800 cm > 1200 cm
Three Modules with two motor & 4 rafters

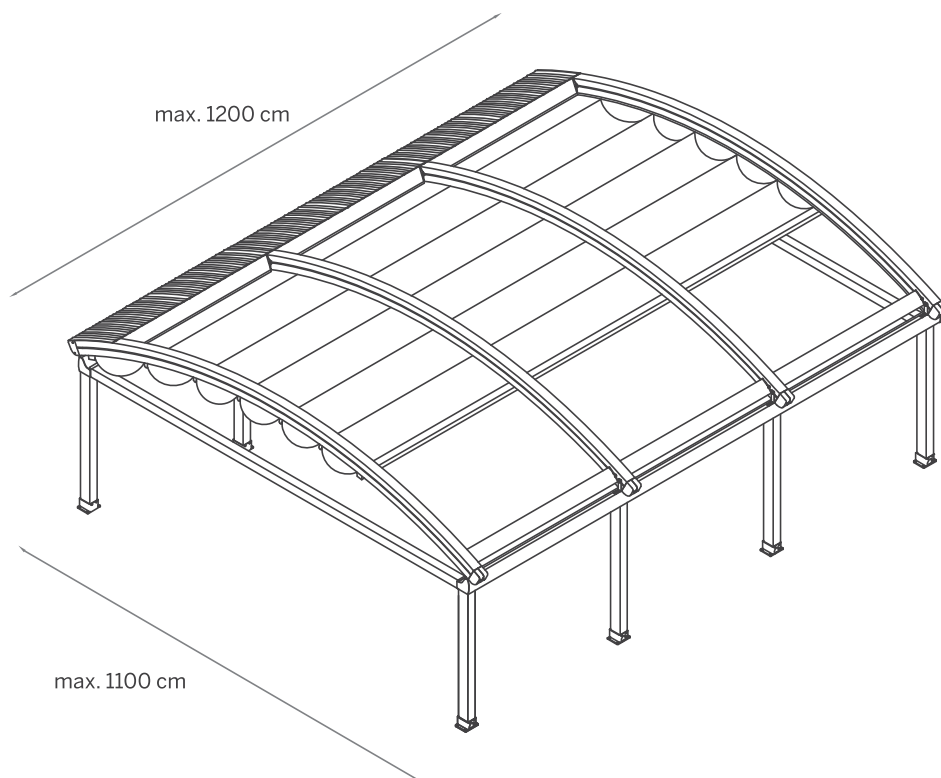

Four Modules

1200 cm > 1300 cm
Four Modules with two motor & 5 rafters

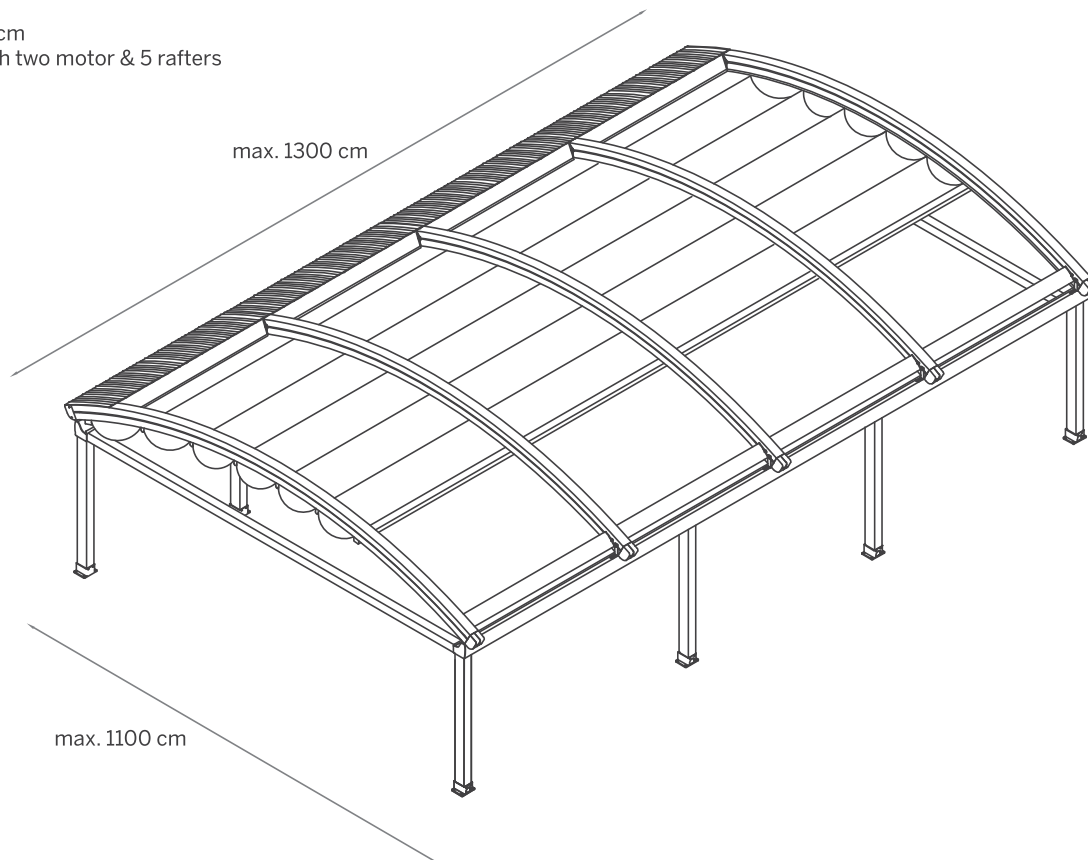

Luna

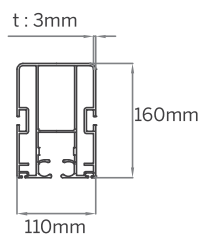
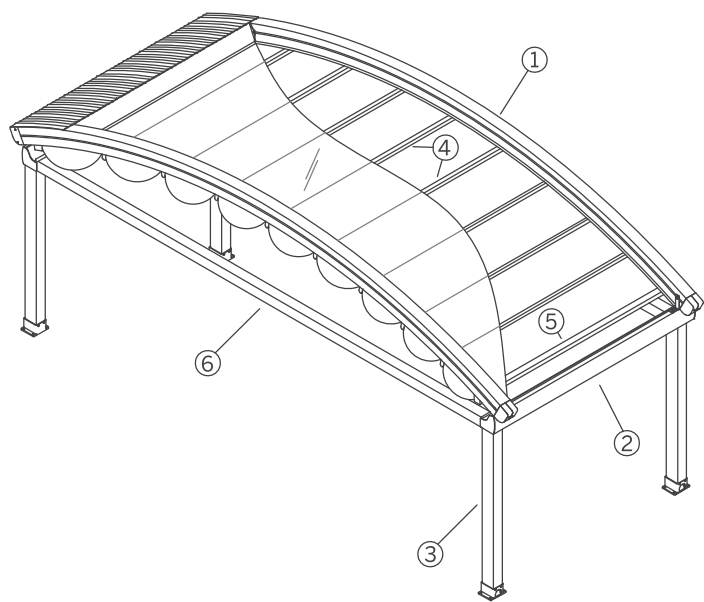

① Rafter

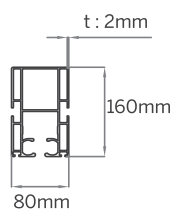

LT

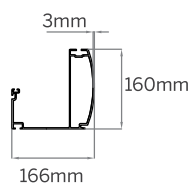

② Gutter

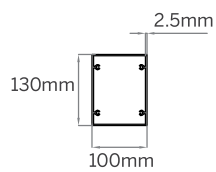

③ Post

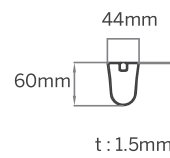

④ Fabric Support (Standart)

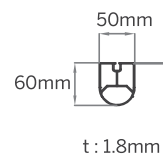

④ Fabric Support (HDD Lux)

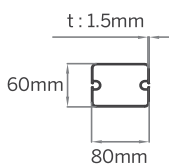

⑤ Puller Profile (Standart)

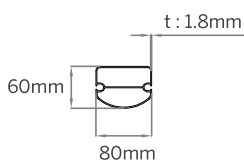

⑤ Puller Profile (HDD Lux)

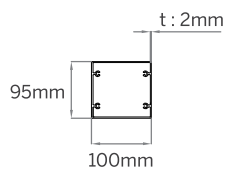

⑥ Side Rafter

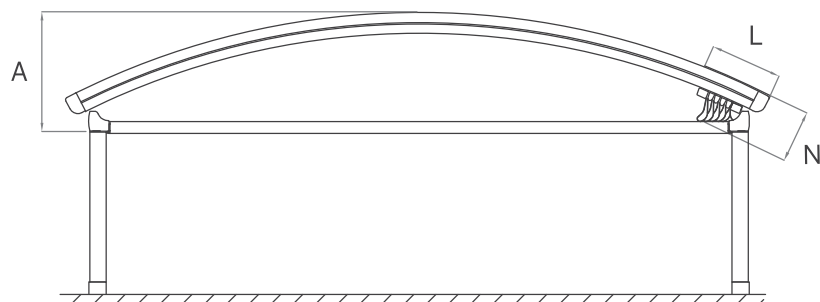

Luna LT

	Fabric Height	Hood	Fall	Fab.Sup.Profiles
	(N*) mm	(L*) mm	(A*) mm	pc*
300	370	731	588	9
350	370	724	705	9
400	370	830	779	11
450	370	962	922	13
500	370	953	843	13
550	370	1066	967	15
600	370	1178	847	17
650	370	1190	949	17
700	370	1281	962	19

*Values can vary by different radius values.

Luna XL

	Fabric Height	Hood	Fall	Fab.Sup.Profiles
	(N*) mm	(L*) mm	(A*) mm	pc*
300	370	755	623	9
350	370	744	740	9
400	370	848	814	11
450	370	968	957	13
500	370	950	878	13
550	370	1078	1002	15
600	370	1178	882	17
650	370	1192	984	17
700	370	1288	997	19
750	370	1406	1101	21
800	370	1390	1086	21
850	370	1493	1189	23
900	370	1502	1137	23
950	370	1612	1234	25
1000	370	1635	1238	25
1050	370	1726	1202	27
1100	370	1724	1202	27

*Values can vary by different radius values.

Luna

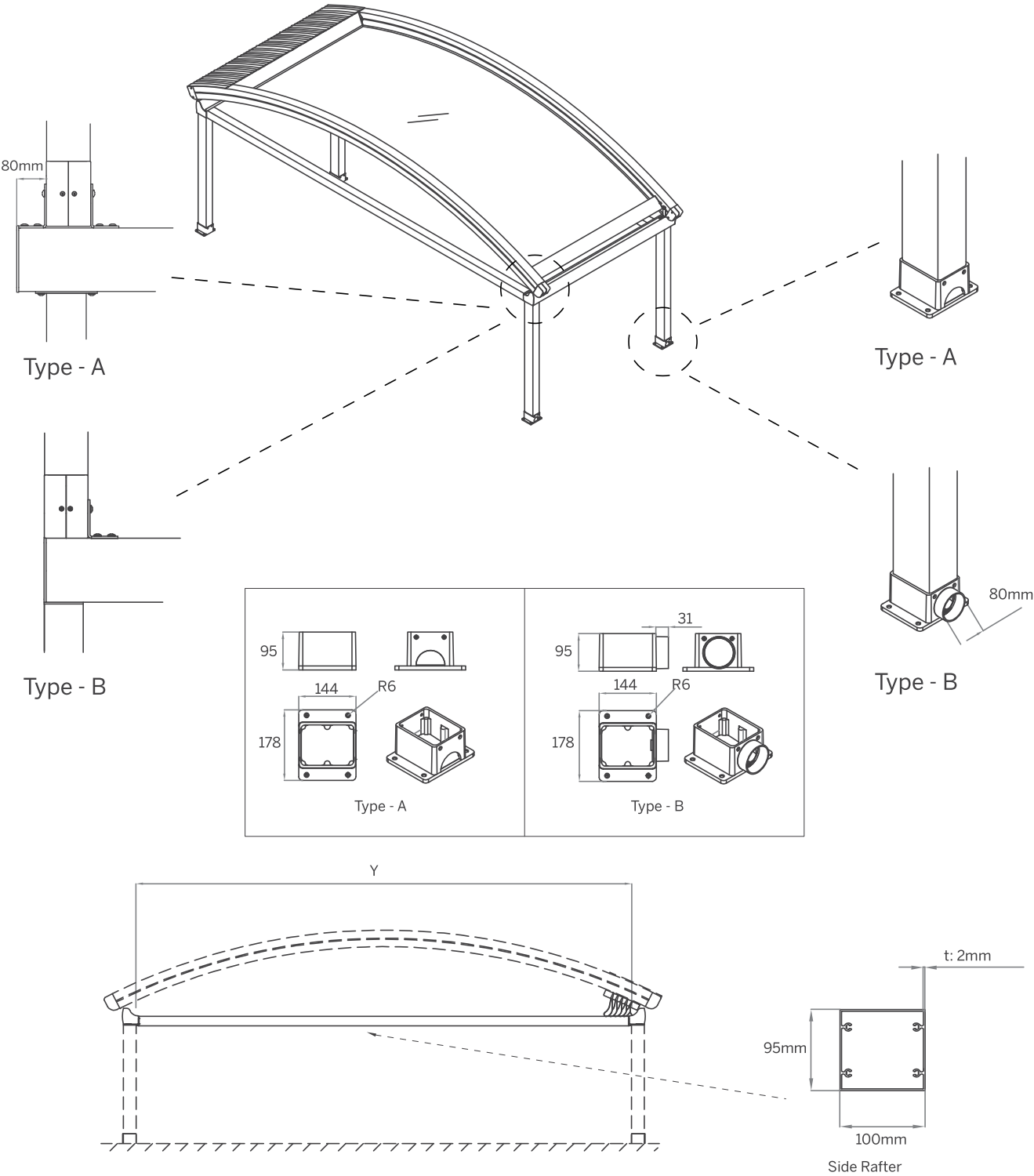

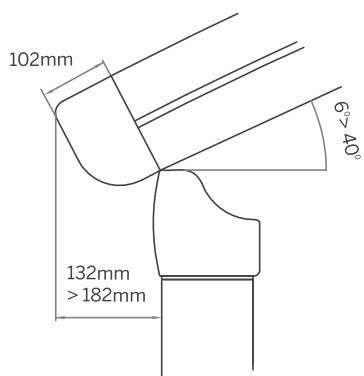
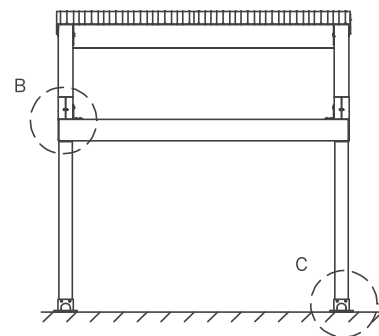
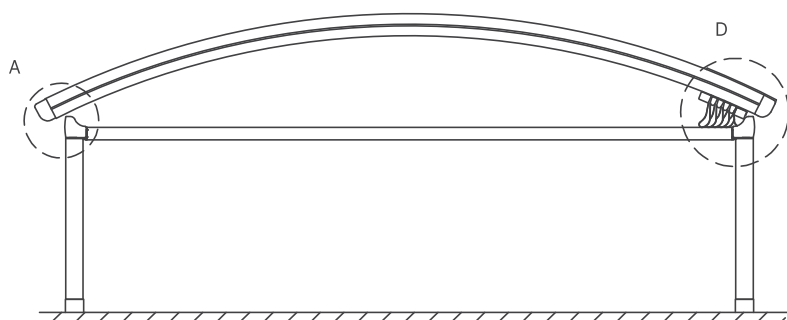

DETAIL A

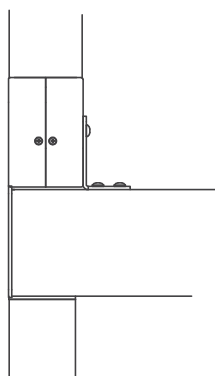

DETAIL B

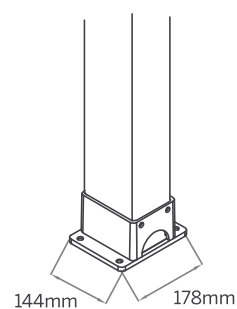

DETAIL C

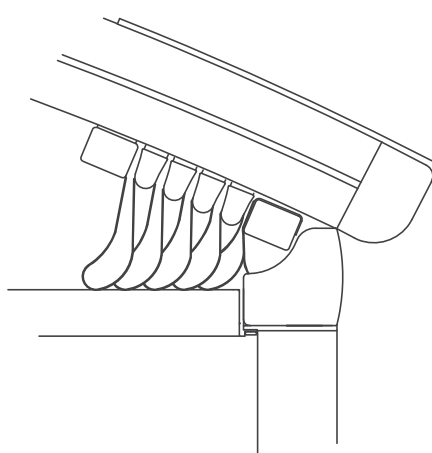

DETAIL D

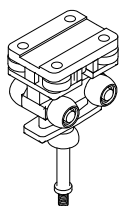

F3 Eight wheel slider

Four horizontal & four vertical rollers working together for perfectly smooth operation every time. The F3 eight wheel system is proven to remove the jamming issue that occurs with the 4 wheel system and can take loads of upto 600KG.

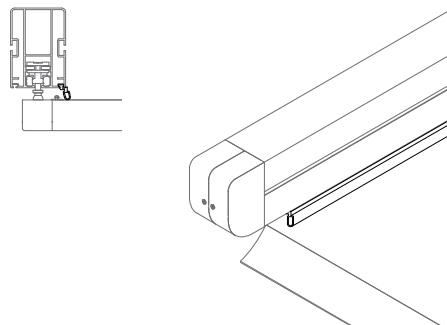

Rafter stormguard edge seal

The rafter Stormguard edge seal stops water from dripping over the side of the system by providing a soft cushioning barrier along the side of the system.

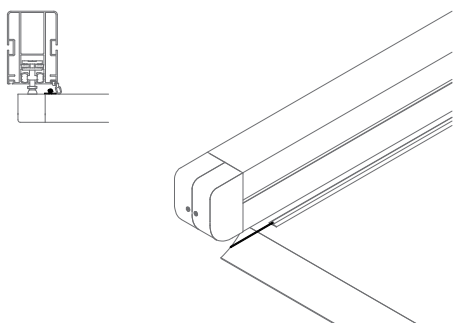

Fabric anti-drop edge cord with electrical cable

The fabric anti-drip edge cord with integrated lighting electrical cable works in conjunction with the Stormguard edge seal to prevent any water leaks over the side of the system.

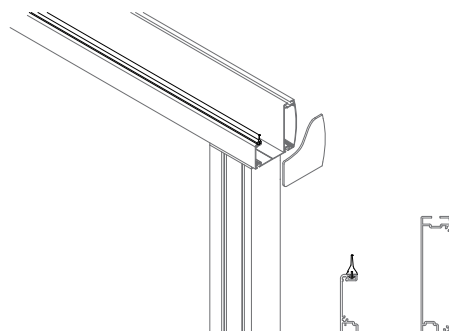

Gutter stormguard seal

The Stormguard gutter seal provides a perfect seal to prevent water leaks along the front of the system from driving rain or splashing from the gutter.

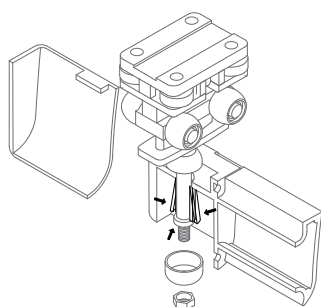

F3 slider easy clip installation

The F3 system has been designed for ease of use, to save time on installations and reduce the number of staff required. Each F3 slider can take loads of upto 600KG once in place.

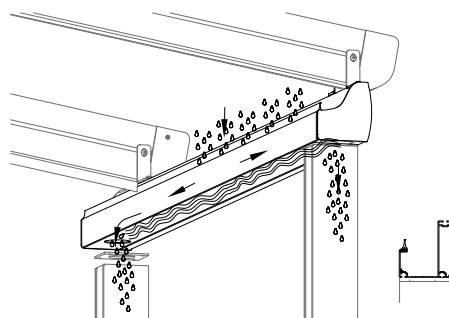

Integrated gutter & internal drainage system

The integrated gutter system provides the perfect solution for water drainage.

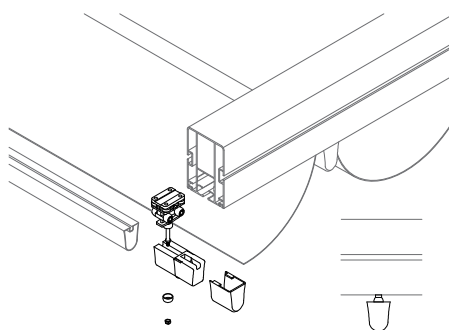

F3 slider and fabric profile assembly

The system has been designed for ease of assembly to save time on installations and reduce the number of staff required.

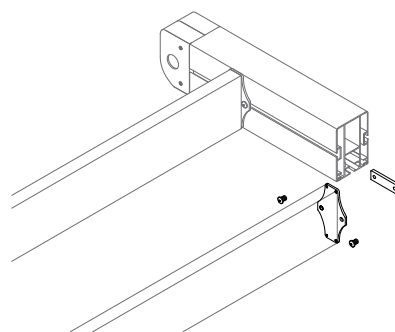

Motorbox support & hood support profile easy installation

Each support profile is easy to install and simple to adjust at the time of installation.

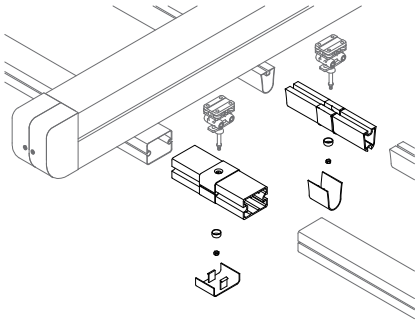

Easy clip intermediate joints (for 2 & 3 module systems)

The Easy clip intermediate joints have been designed for ease of site assembly to save time and reduce the number of staff required.

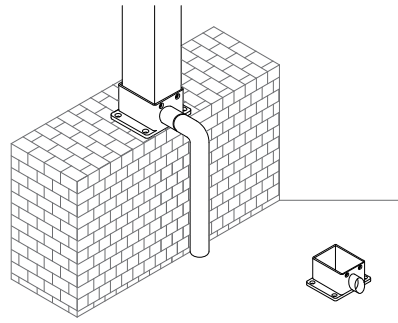

Base plate with external spout

This base plate provides a water dispersal solution.

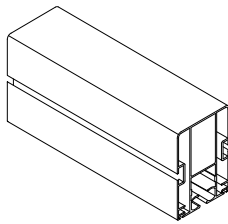

Rafter profile with water guard side channels

The Suntech rafter profiles are designed with water guard side channels for easy installation and to prevent water from entering.

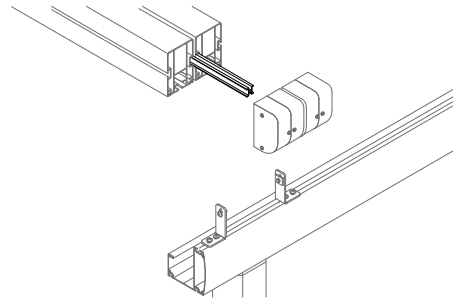

Storm channel for joining system

The storm channel is patented solution for joining two systems side by side with a waterproof join.

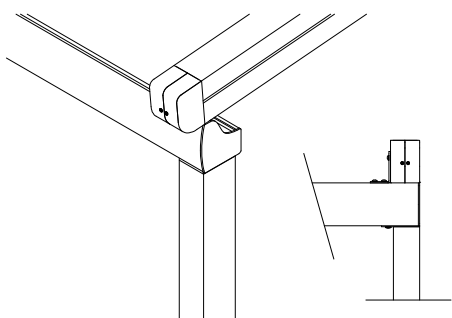

Gutter flush with rafter

Gutter solution for when the system is installed next to a wall or no overhang of the gutter is required.

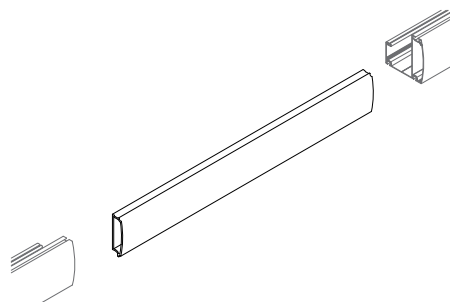

Gutter profile joining piece

A smart solution for joining the gutter profile.

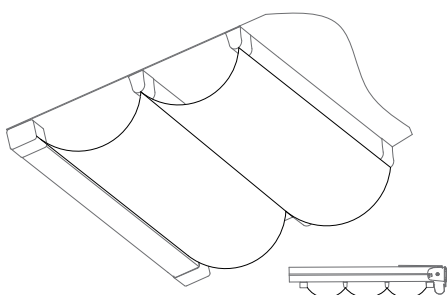

Decorative fabric under layer

The second decorative fabric under layer of fabric can provide an elegant touch of class.

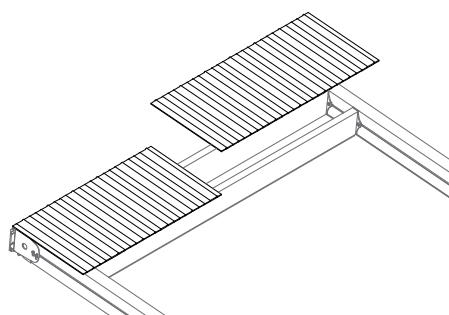

Hood profile sheets

Suntech's hood profile sheets provide an attractive covering solution for the system when not in use. The low profile aesthetic design offer added protection to the system with a chic touch.

Luna

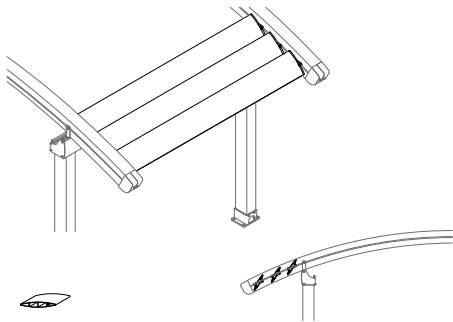

Aerofoil Louvres

The addition of Aerofoil louvres can provide added shade when the system is closed.

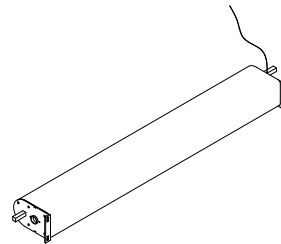

Compact 26rpm direct drive motor box

The Suntech direct drive motor system is a quick and efficient system that drives all conveyer rafters at the same time. The low profile design also allows the fabric to be stored underneath the motor which saves additional space.

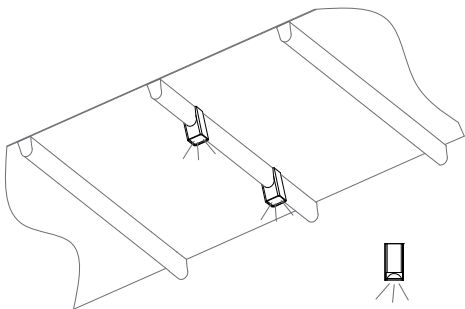

LED-TEC high powered lighting

LED-TEC lighting is a integrated lighting solution that can be added to any Suntech system.

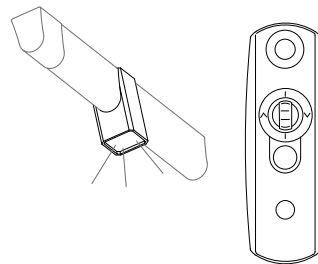

LED-TEC dimmer setup

LED-TEC dimmer lighting is a integrated lighting solution that can be added to any Suntech system.

Luna

type I

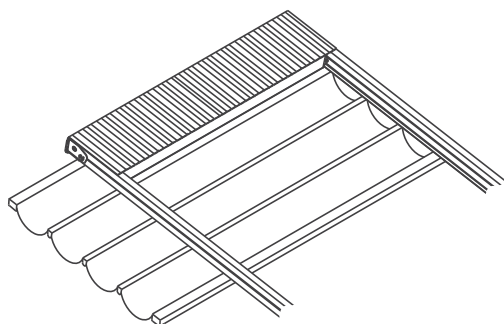

type II

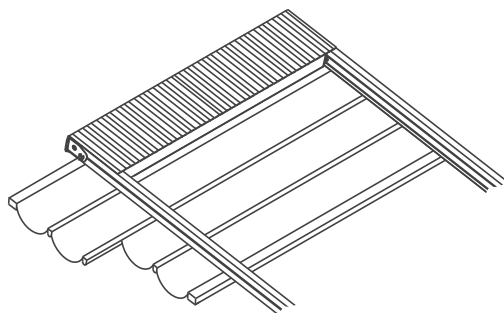

type III

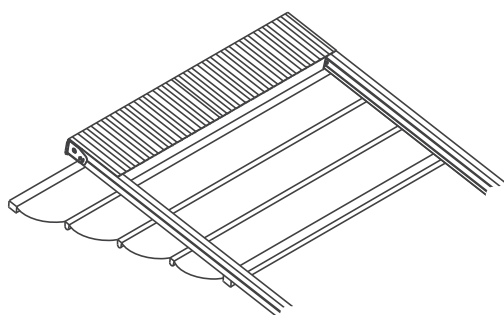

type IV

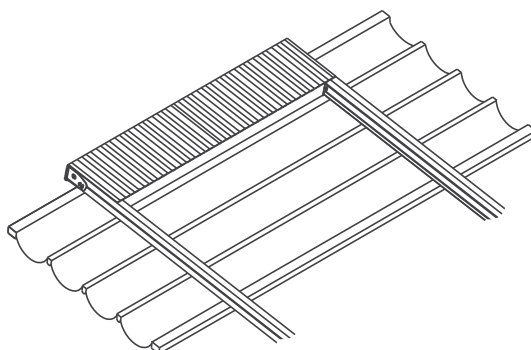

type V

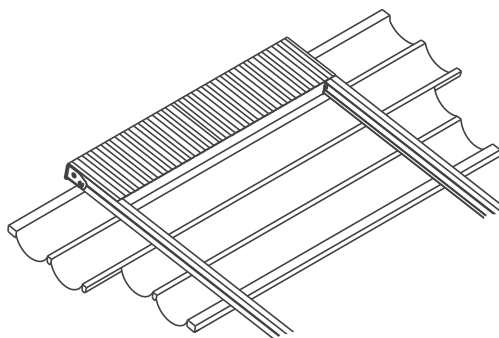

type VI

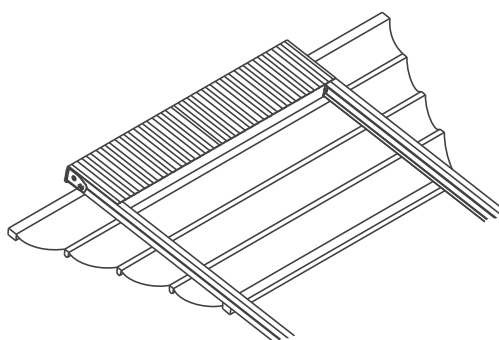

Each system is available with an optional overhang to allow the covered area to protrude past the rafter profile. Site specific overhang solutions such as stepped or wedge shapes are also an effective way to get maximum coverage for your area.

Luna

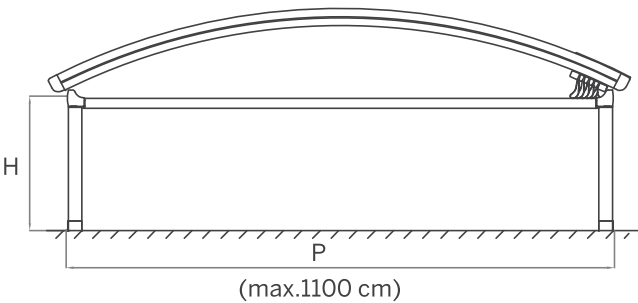

One Module
200 cm > 400 cm
One Module with one motor & 2 rafters

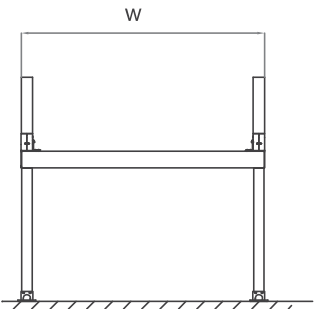

Two Modules
400 cm > 800 cm
Two Modules with one motor & 3 rafters

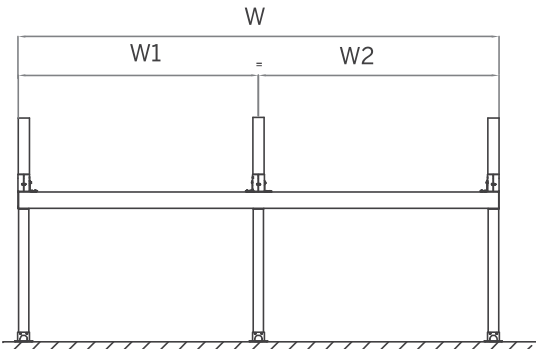

Three Modules
800 cm > 1200 cm
Three Modules with two motors & 4 rafters

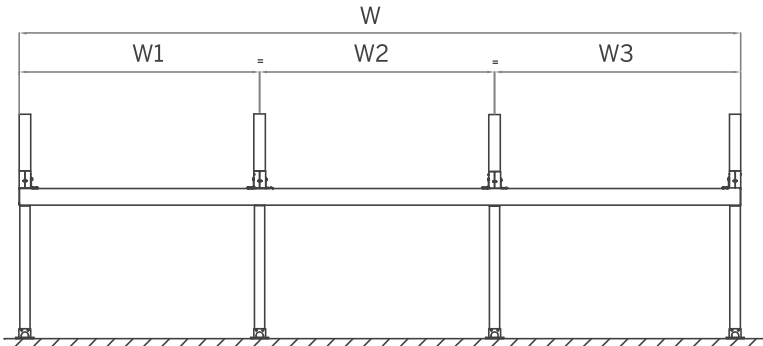

Four Modules
1200 cm > 1300 cm
Four Modules with two motors & 5 rafters

